

Marble Spiral Lift Operation Manual

IMPORTANT: Read this manual thoroughly before operating the toy.

Table of Contents

1. Introduction
2. Safety Information
3. Product Description
4. Battery Installation
5. Operating Instructions
6. Care and Maintenance
7. Troubleshooting
8. Warranty and Service Information
9. Contact Information
10. Compliance and Regulatory Information

1. Introduction

Thank you and congratulations on your new Marblelous set! Discover a world of exciting adventures.! Designed for fun and learning, this toy promises to provide hours of enjoyment. Our unique designs, combined with smart building techniques, let you create marble runs that are truly one of a kind. So get ready for the ride!

We go further than you ever thought possible and beyond any other marble run:
Play different, build smarter!

The Marble Spiral Lift is a versatile Smart-Trick specially designed to lift marbles in what we like to call a 2D setting, and even a 3D setting. 3D means building your marble run on a table or the floor. And 2d would be like building it on a wall. This allows the marble to start a new journey or even become part of a continuous marble run after it has been lifted again. It's made to go with the Marblelous Starter Set.

Please read through this manual to ensure proper use and care of the toy.

2. Safety Information

- Not suitable for children under 3 years.
- Small parts present a choking hazard.
- Do not use near water or in damp conditions.
- Do not disassemble the toy; doing so will void the warranty.

- Remove batteries when the toy is not in use for extended periods.
- Batteries should be inserted under adult supervision.
- Do not mix old and new batteries or different types of batteries.
- **WARNING:** Only use 16mm glass marbles in the Marble Spiral Lift. Using other objects may damage the Spiral and void the warranty.
- **Important:** Make sure the Spiral Lift is securely attached before use.
- **Check regularly:** Make sure the suction mounts or multi-mounts are still stuck firmly in place.

3. Product Description

- **Dimensions:** 23,5 cm (9.25") x 24,5 (9.65") cm x 8 cm (3.15") (L x W x H).
- **Weight:** The product, including its packaging, weighs 500 gr (1.10 lbs).
- **Material:** ABS and Polycarbonate.
- **Power options:** batteries (3x AAA, not included) or USB-C (cable not included).

4. Battery or USB-C Installation

- Ensure the toy is switched off before inserting batteries.
- Open the battery compartment with a screwdriver.
- Insert 3 AAA batteries, ensuring correct polarity.
- Close and secure the battery compartment.
- Plug the USB-C cable (not included) into the designated port.
- Connect your USB-C cable to a USB power supply or power bank (not included).

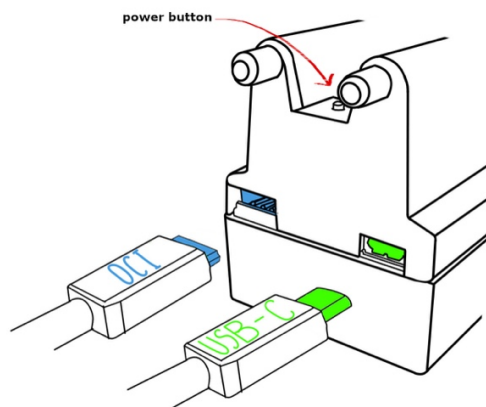

Please note: the use of batteries is fine for offline mode, but we **recommend** powering the Smart-Trick with a power bank or a USB power supply—especially if you plan to use it in Wi-Fi mode.

5. Operating Instructions

- **Setting up the Spiral Lift**

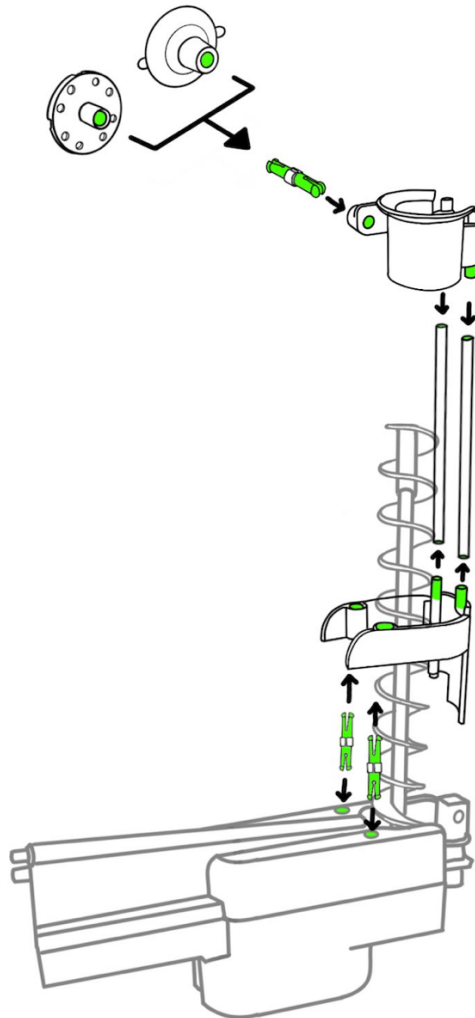

- **Prepare the Base:**

- Grab the spiral element with the orange gear.
- Insert the orange gear into the base slot until it clicks securely into place.
- Insert two connectors into the designated holes in the base.
- Attach the Orange C Clip with the long side facing down.

- **Build the Spiral Lift:**

- Insert paper straws into the white Spiral Mounts with the rounded end facing up.
- Attach the white Spiral Mounts with the straws to the Orange C Clip.
- To add more height, connect additional spiral elements by aligning the tab of one element with the slot in the previous one.
- Secure each additional spiral element with straws and white Spiral Mounts.

- **Mount the Spiral Lift:**
 - Insert three basic connectors into the base.
 - Insert one basic connector into each white Spiral Mount.
 - Attach either multi-mounts or Suction Mounts to the connectors.
 - Secure the Spiral to the wall or build it into your 3D LEGO® setting on the table using the attached mounts.
 - Tip: if you want to attach the Spiral Lift using suction cups, don't forget to slightly wet the cups for a better grip on smooth surfaces. And if you want the Smart-Trick to stay up for more than a few weeks, give the suction cups a little press every once in a while to make sure it's nice and secure.
- **Pro tip:** To ensure optimal performance, keep the Spiral Lift as upright as you can.
- **Switching On/Off:** To toggle the device (turn on or off), press and hold the little red power button for **2** seconds. The LED indicator light will turn green, and after that release the button. That's it; the Spiral Lift is ready to use!
- **Wi-Fi mode:** To toggle Wi-Fi (turn on or off), press and hold the red power button for **5** seconds (it does not matter whether the Spiral Lift is on or off). It's ready when the LED indicator starts flashing yellow and beeps twice. Let go of the red power button, and now the LED indicator turns blue, meaning the Spiral Lift is in connection mode.
- **Factory reset:** Press and hold the little red button for **10** seconds. The LED indicator will be flashing yellow quickly and a beeping sound will play. Now, release the red button and if the LED indicator briefly turns green, the reset to factory settings is complete.
- **LED Indicators:**
 - **Green:** Shortly when turned on or off in non-Wi-Fi mode and after a factory reset.
 - **Yellow:** Short blinks: they let you know you can release the arrow when you reach the desired mode (like Wi-Fi mode or factory reset):
 - One blink when device turned off.
 - Two blinks when toggling for Wi-Fi.
 - Multiple blinks to indicate a factory reset.
 - **Blue:** The Spiral Lift is in Wi-Fi connection mode.
- **Control:** To activate the Spiral Lift (whether it's connected to Wi-Fi or not), just let a marble pass through the little sensor at the start in The Spiral Lift's little tray, and it will automatically start. Shortly after the marble is lifted and released, the Spiral Lift will automatically stop. If you're connected to Wi-Fi, you can also use the Marblelous app. It's like having a remote control!

- **App interactive features:** The many possibilities of the Marblelous app really highlight the versatility of our Smart-Tricks. With the app you can:
 - **Remotely start:** Start the Spiral Lift remotely.
 - **Adjust volume:** You can adjust the volume of the internal speaker.
 - **Identify:** You can identify which Spiral Lift you're controlling if you have more than one.
 - **Power off:** You can power the Smart-Trick off directly from the app.
 - **Set automations:** These let you create "if this, then that" scenarios. For a deeper dive into automations, please visit our YouTube channel (link below) for in-depth tutorials.
 - **Sync it up:** Combine the Spiral Lift with other Smart-Tricks, like the Marblelous Detector or the Dropper. With the app, you can link them up so that, for instance, when a marble passes the Spiral Lift, it activates the Dropper. Please check out our YouTube channel (link below) on how to set up such an **automation**.
 - **Adjust the number of Spirals and when to stop spinning:** Easily customize the height of your Lift by adjusting the number of spirals. Based on the number of spirals, the device automatically stops spinning at a certain point.

Please note: Don't forget to save your changes, like the number of spiral elements connected, by clicking the submit button.

How to get ready (and more) with the Marblelous app?

Connect the Spiral Lift to the app: If you want to connect the Spiral Lift to the Marblelous app, first make sure your Smart-Trick is in Wi-Fi mode (as explained above). Then, download the Marblelous app from the Google Play Store or Apple App Store if you haven't already. Once you open it, tap the icon at the bottom of the screen to open the TRICKS page.

On the TRICKS page, press the "+" in the top right corner. Then, tap Add NEW Smart-Trick and select the Spiral Lift from the list.

Also, make sure your phone is connected to a Wi-Fi network and not mobile data. When you made sure of that just tap NEXT. Please wait while the process is completed.

As soon as the app finds the Spiral Lift, it will ask you for your Wi-Fi network (choose the same network as your Spiral Lift) and password. Fill in your password, wait a moment, and you will see a success screen.

Update firmware: Down at the bottom, you'll find the firmware section where you can update the firmware of your Spiral Lift (if there is a new update).

Delete Smart-Trick from app: After selecting a Smart-Trick from the TRICKS page, you'll find the delete option down at the bottom.

Recover deleted Spiral Lift from the app: Did you intentionally or accidentally delete your Smart-Trick and want to recover it? No worries! Just tap the plus icon again and add it back by pressing "add existing Smart-Trick". No need to start from scratch. A message will appear with your deleted Smart-Trick.

Hook up to Smart Home devices (not included): Want to connect your Smart-Trick to your smart home and make your Smart-Trick even smarter? You can easily connect it to your Sonos or Philips Hue with an **automation**. Please check our YouTube channel (link below) for in-depth tutorials.

Disclaimer: "Marblelous is compatible with LEGO® bricks. LEGO® is a trademark of the LEGO® Group, which does not sponsor, authorize, or endorse this product."

6. Care and Maintenance

- Wipe the toy with a clean, dry cloth.
- Do not use harsh chemicals or detergents.
- Do not immerse the toy in water.
- Store in a dry place away from direct sunlight.
- Only use 16mm glass marbles in the Spiral Lift. Using other objects may damage the Spiral Lift and void the warranty.

7. Troubleshooting and tips

- **Problem:** The marble is having trouble going up the spiral. Try making the spiral as vertical as you can.
- **Problem:** Spiral Lift does not turn on. If you use batteries, check that they are correctly installed and charged. In case your Smart-Trick is powered with a USB-C cable together with a power bank or a USB power supply, check if you connected them correctly and that the power bank is charged.

- **Problem:** The Spiral Lift stops working during use.
 - Check if your power bank or batteries are charged and that everything is still correctly connected.
 - If you are using a power bank, the issue might be that the power bank thinks there is no device connected anymore, even though it is. The power consumption of the Smart-Trick is very low and as a result, the power bank can turn itself off because it thinks that the Smart-Trick is no longer in use. This is sometimes (informally) called "false idle detection". However, this isn't an issue for our Smart-Tricks. They have a built-in feature that you can activate in the Marblelous app to solve this problem. Tip: If you're looking for a new power bank, consider one with a low-power mode. Check our YouTube channel (link below) for instructions.
 - Please make sure that only 16 mm glass marbles are entering the Spiral Lift. If not, that could damage the Smart-Trick and prevent it from working correctly. For safety reasons, the Spiral Lift will immediately stop spinning if anything blocks it.
- **Problem:** The marble is falling between the straws as it goes up. Try adding an extra basic carrier in the middle to support the two straws. This will prevent the straws from accidentally bending under the pressure of the upward moving marble. Also, check if your marbles are the right size. Maybe you are using your own marbles which could be a little bit too small.
- **Problem:** The Spiral Lift is powered on but the marble isn't starting it up? Check if something is blocking the sensor at the beginning of the Spiral Lift. If so, remove it. Try waving your hand directly over the sensor to see if it works.
- **Problem:** The app isn't responding to the Spiral Lift? Double-check that you've connected the Spiral Lift correctly as described in the manual. If you have multiple Spiral Lifts to choose from, make sure you're connected to the right one. Also, ensure both your app and the Spiral Lift are connected to the same Wi-Fi network and that the Spiral Lift is in Wi-Fi mode.
- **Problem:** My automation in the app isn't working. Did you save the automation correctly? Is the Spiral Lift turned on and in Wi-Fi mode? Check the instructions above on how to do this.
- **Problem:** I'm having trouble locating the Spiral Lift within the app. Please ensure that you've added it correctly.

- **Problem:** The Spiral Lift is **not connecting to Wi-Fi**.
 - Please check the instructions above for details on how to put the Smart-Trick into Wi-Fi mode.
 - Even if you have carefully followed all the instructions for connecting to Wi-Fi, there might still be other reasons why it's not working. Are you trying to connect your Smart-Trick to a guest Wi-Fi network? These public and open networks (hotels, B&B's, etc) often have configurations that can prevent your Smart-Trick from connecting. Marblelous has no control over these settings.
- **Problem:** The app is unable to detect my Wi-Fi network. Please ensure that your router is powered on and that Wi-Fi is enabled on your phone.
- **Problem:** You have multiple Spiral Lifts, and you can't tell which Spiral Lift you're connected to? Use the identify function in the app to determine which one you're connected to. Please note that this function only works when the device is connected to Wi-Fi.
- **Pro tip:** As mentioned before, keep the Spiral Lift as upright as you can to ensure optimal performance.
- **Tip:** As mentioned before, if you want to attach the Spiral Lift using suction cups, don't forget to slightly wet the cups for a better grip on smooth surfaces. And if you want the Smart-Trick to stay up for more than a few weeks, give the suction cups a little press every once in a while to make sure it's nice and secure.
- **Tip:** If you want to attach the Spiral Lift using multi-mounts on a wall or surface that is not smooth, you could use adhesive putty or removable mounting gum (not included) on the back of your multi-mount. Just be gentle with delicate surfaces like wallpaper.

Want to check out even more tips, tricks and troubleshooting? Visit the links below.

www.marblelous.tech/spiral



Marblelous Spiral Lift

www.marblelous.tech/troubleshootingtips



Troubleshooting and Tips

www.youtube.com/@marblelous



YouTube channel

8. Warranty and Service Information

- This toy is covered by a 24 months warranty from the date of purchase.
- The warranty covers manufacturing defects but not damage from improper use or accidents.

9. Contact Information

For customer support, please contact:

- **Email:** info@marblelous.tech
- **Website:** www.marblelous.tech

10. Compliance and Regulatory Information

This product complies with all applicable safety standards and regulations, including the requirements for the CE marking as set out in European directives, and the FCC regulations as prescribed by the Federal Communications Commission. The product has been tested and certified to meet the relevant safety requirements and standards, and is suitable for use according to the manufacturer's specifications.

Marblelous Tech wishes you and your friends endless fun and creativity with Marblelous!